

Technical specification

3~ 50 Hz

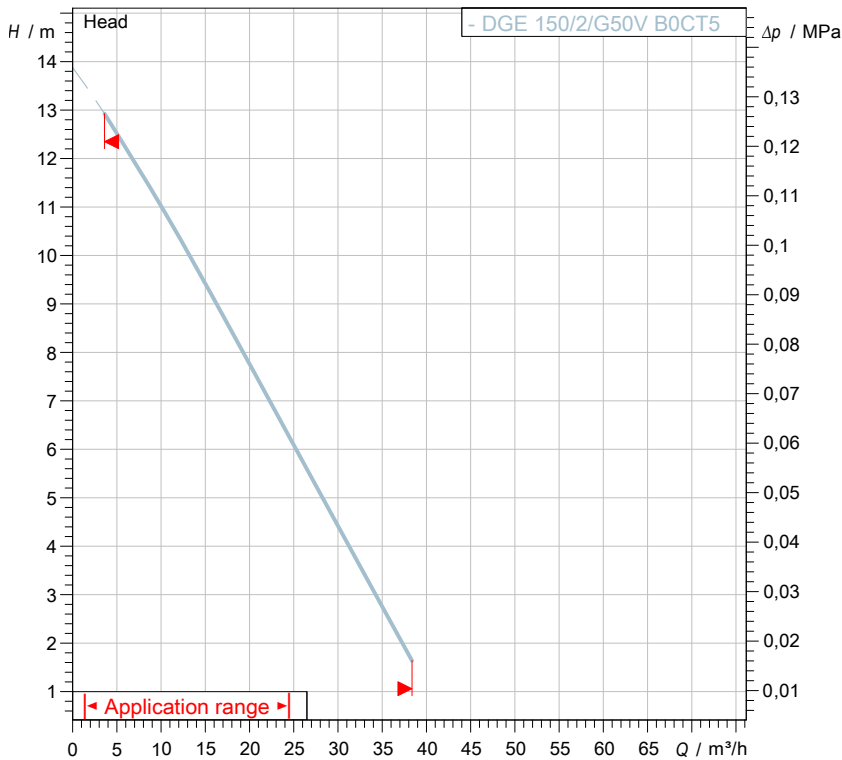

Characteristic curves according to UNI EN ISO 9906:2012

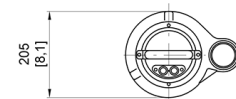
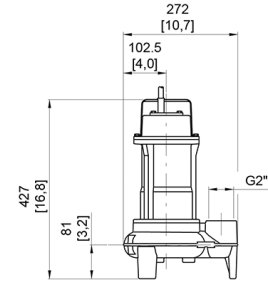

[mm]
[inch]

Pump

| | |
|---------------|----------------------|
| Series | E series |
| Pump name | DGE 150/2/G50V B0CT5 |
| Configuration | NGNAQ21040N00NN |
| Standard | EN 809:2009 |

Motor data

| | |
|----------------------|-----------------|
| Rated voltage | 400 V |
| Frequency | 50 Hz |
| Motor phases | 3~ |
| Number of poles | 2 |
| Rated power P2 | 1,1 kW |
| Incoming power P1 | 1,5 kW |
| Rated current | 2,6 A |
| rpm | 2642 1/min |
| Efficiency | 66,6 % |
| cos φ | 0,86 |
| Rated torque | 4,0 Nm |
| Start | Direct starting |
| Degree of protection | IP 68 |
| Insulation class | F |

Hydraulic

| | |
|-----------------|----------------------|
| Type | DG (Set-back Vortex) |
| Free passage | 50 mm |
| Impeller type | Vortex impeller |
| Discharge | G 2" - |
| Curve tolerance | UNI EN ISO 9906:2012 |

Operating limits (standard pumps)

| | |
|---|---------------------|
| Max. ambient temperature | 40 °C |
| Max. density treated liquid | 1 100 kg/m³ |
| Max. immersion depth | 20 m |
| pH treated liquid | 6 ÷ 14 |
| Max. start per hour (equally distributed) | 30 |
| Wet/dry use | WET |
| Max. acoustic pressure level | 70 dB |
| Operating mode | S1 - Continuous use |

Construction materials

| | |
|------------------|-------------------------------|
| Case | Cast iron EN-GJL 250 |
| Shaft | Stainless steel - AISI 420 |
| Hydraulic | Cast iron EN-GJL 250 |
| Impeller | Cast iron EN-GJL 250 |
| Painting/Coating | Bi-epoxy 80 μm |
| Screws | Stainless steel - Class A2-70 |
| Gaskets | NBR |

Construction features

| | |
|---------------------|-------------------------------------|
| Cooling system | No cooling jacket |
| Main cable | 4G1 |
| Control cable | - |
| Cable length | 10 mt |
| Mechanical seals | 1 in silicon carbide and 1 lip seal |
| Additional drilling | - |
| Weight* | 20 kg |
| Electrical variant | No electrical device equipped |

* cable's weight not included



water solutions

Data sheet

SAT-V 150/2/50/D-DGE 150/2/G50VB0CT5

E series

Pump performance curves

3~ 50 Hz

| | | | | | |
|--|----------------------------------|-----------------------|----------------------|------------------------------------|---------------------------------------|
| Hydraulic type DG (Set-back Vortex) | Impeller type Vortex impeller | Free passage 50 mm | Discharge G 2" | Suction - | |
| DUTY POINT | | | | | |
| Flow | Head | Shaft power P2 | Hydraulic efficiency | Density 998,3 kg/m ³ | Viscosity 1,005 mm ² /s |

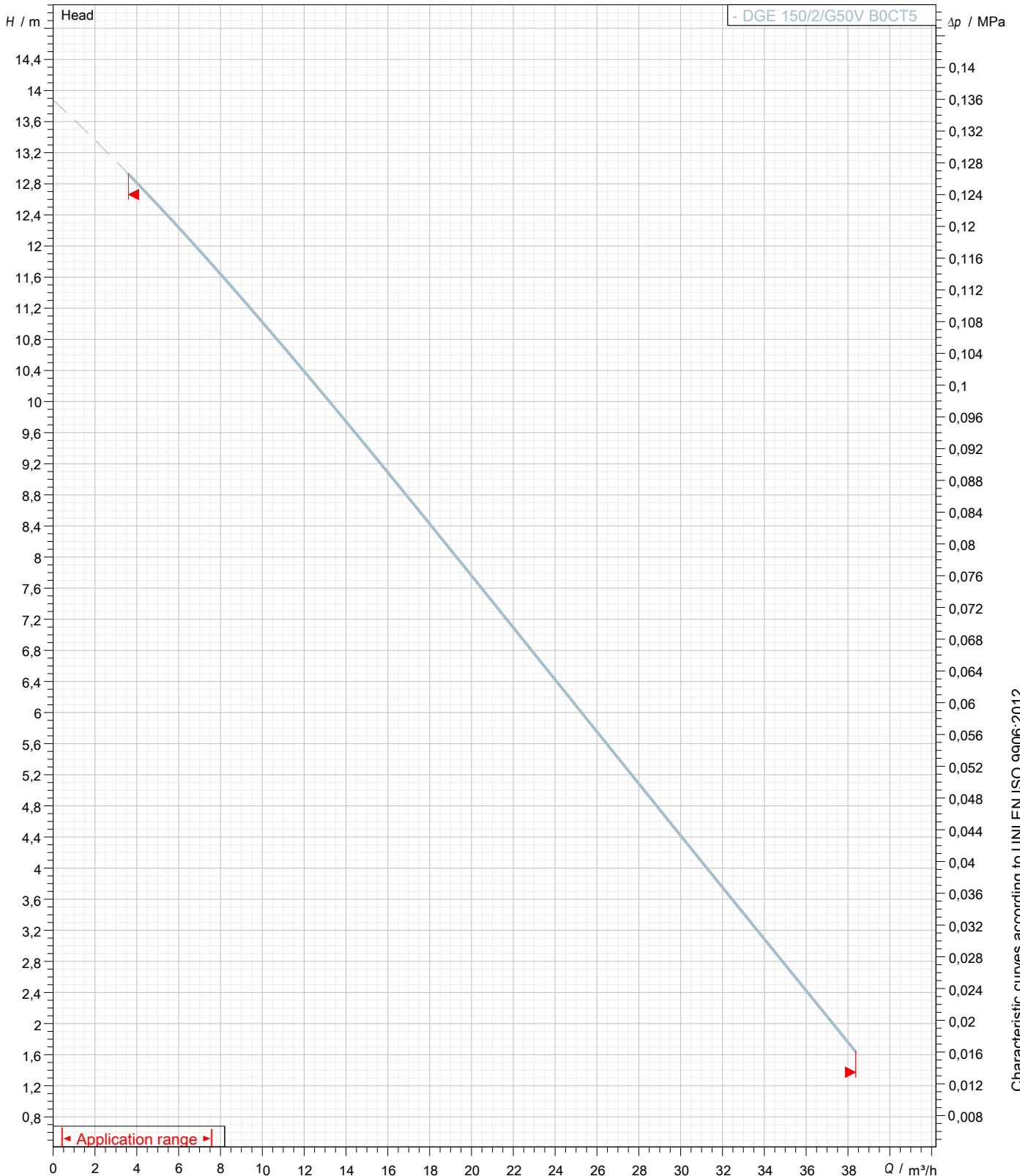

Characteristic curves according to UNI EN ISO 9906:2012